

PROPRIETARY NOTICE

This document discloses confidential subject matter in which MilesTek Corporation and its subsidiaries have proprietary rights. Neither receipt nor possession thereof confers or transfers any right to reproduce or disclose the document, any part thereof, any information contained therein, or any physical article or device, or to practice any method or process, except by written permission from, or written agreement with MilesTek Corporation and its subsidiaries.

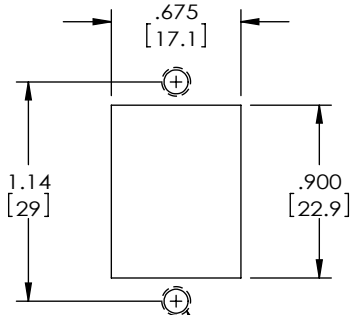

RECOMMENDED
PANEL OPENING

2X #4-40 UNC-2B THRU

NOTES:

MATERIAL:
FLANGED ADAPTOR: ZINC ALLOY
HARDWARE: STAINLESS STEEL.

FINISH:
FLANGED ADAPTOR: NICKEL PLATE.

MISCELLANEOUS:
VOLTAGE RATING: 36V

PACKAGING:
KITS SHALL BE INDIVIDUALLY PACKAGED IN ACCORDANCE WITH SPEC. PS-0054.

REGULATORY COMPLIANCE:
CE2011/65/EU(RoHS DIRECTIVE)



2X 4-40UNC-2A X 1/4" LONG

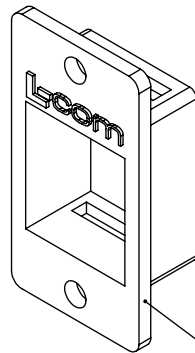

FLANGE MOUNTED KEYSTONE ADAPTOR

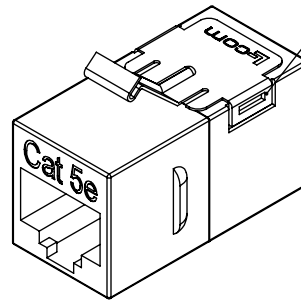

CAT 5E SHIELDED KEYSTONE
FEED-THRU COUPLER
(L-COM P/N: TDG1026KS-C5E
WITHOUT PACKAGING)

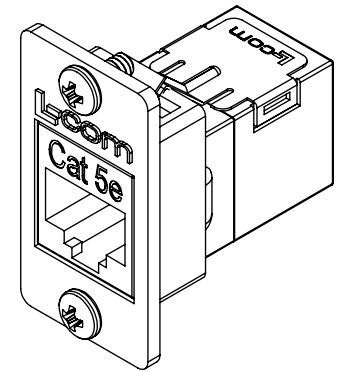

KIT SHOWN FULLY ASSEMBLED FOR CLARITY
(KIT IS SHIPPED UN-ASSEMBLED)

KIT INCLUDES:
1- SHIELDED COUPLER
1- FLANGE ADAPTOR
1- PACKAGE MOUNTING SCREWS (4-40x 1/4")

NON CONTROLLED DRAWING IF PRINTED

AS9100C CERTIFIED			CAD SYSTEM DRAWING - DO NOT REVISE MANUALLY			
			SIGNATURE	DATE	<p>MILESTEK CORPORATION 1506 INTERSTATE 35 WEST DENTON, TX 76207 PHONE: 866.524.1553 FAX: 940.591.7086</p>	
			DRAWN BY: G.HUAN	06/13/17		
			CHECKED BY: D. GUITADAURO	06/14/17	TITLE CAT 5E SHLD RJ45 PNL CPLR KIT	
			APPROVED ENGINEERING: S.PAN	06/14/17		
			APPROVED MANUFACTURING:		DRAWING NUMBER: T5C00002	
			CUSTOMER APPROVAL			
DASH	NEXT ASSY	USED ON	CAGE CODE: 42977		SCALE: NTS	SHEET 1 OF 1
APPLICATION			CUSTOMER REFERENCE DOCUMENT:			

UNLESS OTHERWISE SPECIFIED ALL
DIMENSIONS ARE IN INCHES

OVERALL CABLE LENGTH TOLERANCE:
≤12 [305] = +1 [25] / -0
>12 [305] ≤60 [1524] = +2 [51] / -0
>60 [1524] ≤120 [3048] = +4 [102] / -0
>120 [3048] ≤300 [7620] = +6 [152] / -0
>300 [7620] = +5% / -0%

ALL OTHER DIMENSIONAL TOLERANCES:
.X = ±.2 [5.08]
.XX = ±.02 [1.51]
.XXX = ±.005 [1.3]

APPROVED MANUFACTURING: