

PROPRIETARY NOTICE
This document discloses confidential subject matter in which MilesTek Corporation and its subsidiaries have proprietary rights. Neither receipt nor possession thereof confers or transfers any right to reproduce or disclose the document, any part thereof, any information contained therein, or any physical article or device, or to practice any method or process, except by written permission from, or written agreement with MilesTek Corporation and its subsidiaries.

REV	REVISIONS		DATE	APPROVED
	DESCRIPTION			
A	INITIAL RELEASE		6/5/18	D.FRISIELLO
B				

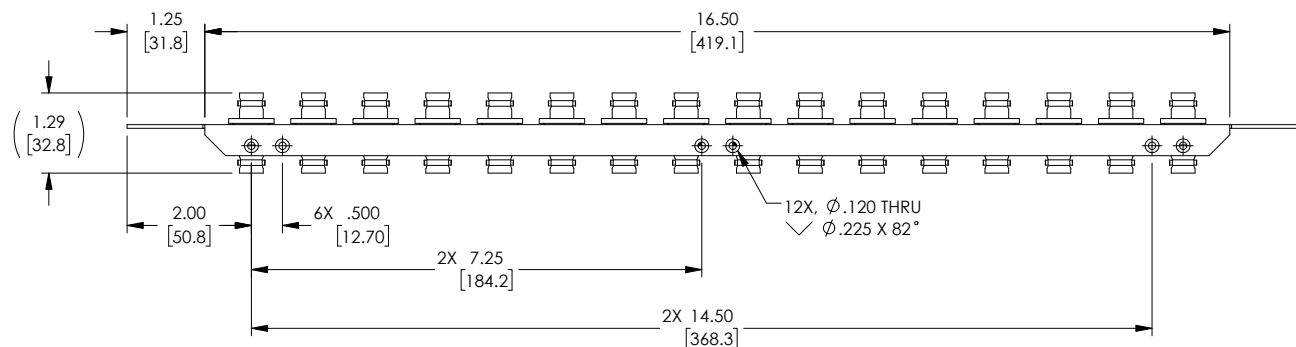
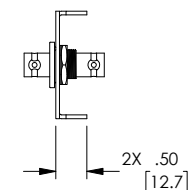
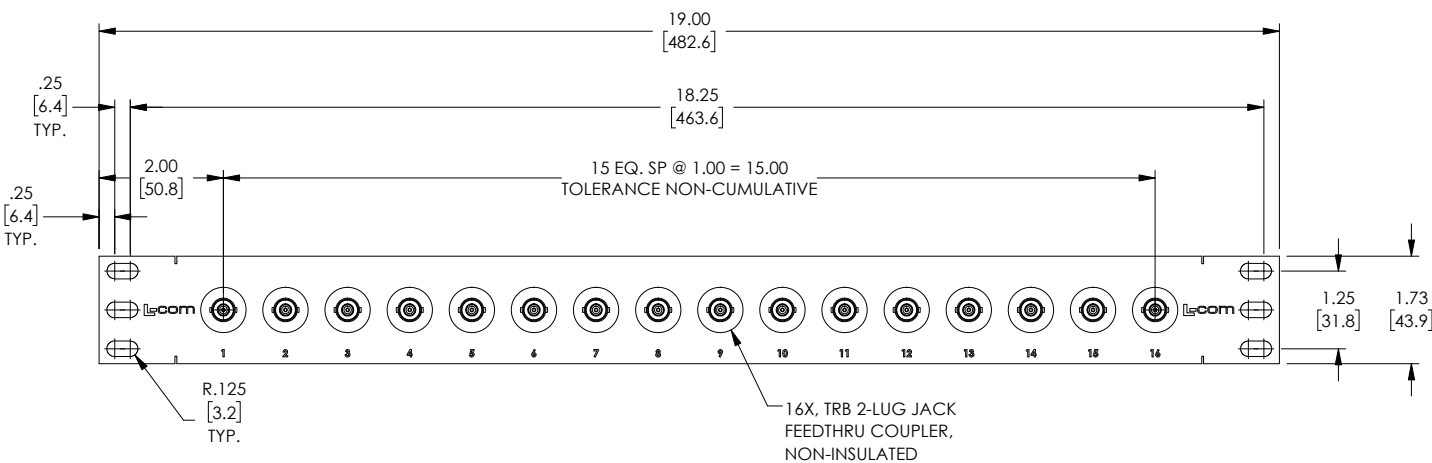

NOTES:

1. MATERIAL: .06 THICK COLD ROLLED STEEL.
2. FINISH: FLAT BLACK POWDER COAT.
3. PANEL ASSEMBLY SHALL BE INDIVIDUALLY PACKAGED IN ACCORDANCE WITH L-COM SPECIFICATION PS-0054.

REGULATORY COMPLIANCE:
CE2011/65/EU(ROHS DIRECTIVE)

NON CONTROLLED DRAWING IF PRINTED

AS9100C CERTIFIED		CAD SYSTEM DRAWING - DO NOT REVISE MANUALLY	
		SIGNATURE	DATE
		D.FRISIELLO	6/5/18
		M.MARTINEZ	6/5/18
		M.MARTINEZ	6/5/18
		CUSTOMER APPROVAL	
DASH	NEXT ASSY	USED ON	CUSTOMER REFERENCE DOCUMENT
APPLICATION		CAGE CODE: 42977	
		SCALE: NIS	
		SHEET 1 OF 1	