

PROPRIETARY NOTICE

This document discloses confidential subject matter in which MilesTek Corporation and its subsidiaries have proprietary rights. Neither receipt nor possession thereof confers or transfers any right to reproduce or disclose the document, any part thereof, any information contained therein, or any physical article or device, or to practice any method or process, except by written permission from, or written agreement with MilesTek Corporation and its subsidiaries.

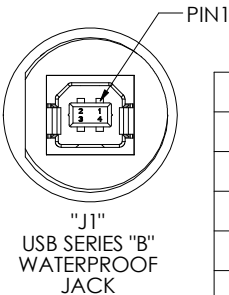

WIRING MAP	
PIN#	COLOR
1	RED
2	WHITE
3	GREEN
4	BLACK
SHELL	GRAY

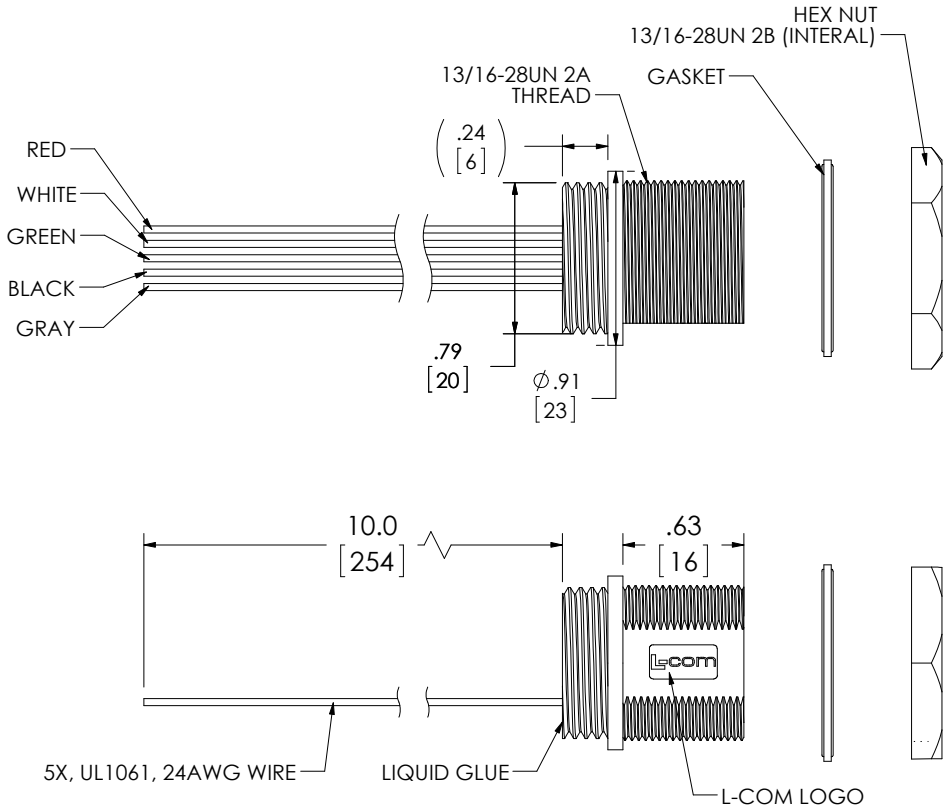
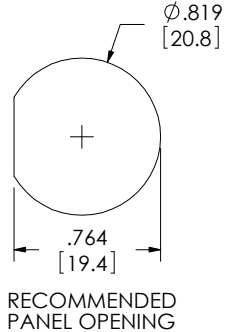

- NOTES:**
- 1.COMPONENT ASSEMBLY SHALL BE TESTED FOR CONTINUITY.
 - 2.L-COM LOGO STYLE MAY VARY PER L-COM SPECIFICATION
 - 3.INGRESS PROTECTION RATING IS IP67 (J1 ONLY ,MATED)
 - 4.COMPONENT ASSEMBLY SHALL BE INDIVIDUALLY PACKAGED IN ACCORDANCE WITH SPECIFICATION PS-0054.

REGULATORY COMPLIANCE:
CE2011/65/EU(RoHS DIRECTIVE)

NON CONTROLLED DRAWING IF PRINTED

AS9100C CERTIFIED			CAD SYSTEM DRAWING - DO NOT REVISE MANUALLY			
			SIGNATURE	DATE	MilesTek	
			DRAWN BY: J.YOU	06/13/17	MILESTEK CORPORATION 1506 INTERSTATE 35 WEST DENTON, TX 76207 PHONE: 866.524.1553 FAX: 940.591.7086	
			CHECKED BY: B.GATES	06/13/17	TITLE	
			APPROVED ENGINEERING: S.PAN	06/13/17	USB WATERPROOF SERIES B BULKHEAD TO BLUNT END	
			APPROVED MANUFACTURING:		SIZE	
			CUSTOMER APPROVAL		DRAWING NUMBER:	
					A MUS2A00007	
DASH	NEXT ASSY	USED ON	CAGE CODE: 42977		SCALE: NTS	SHEET 1 OF 1
APPLICATION						