

PROPRIETARY NOTICE

This document discloses confidential subject matter in which MilesTek Corporation and its subsidiaries have proprietary rights. Neither receipt nor possession thereof confers or transfers any right to reproduce or disclose the document, any part thereof, any information contained therein, or any physical article or device, or to practice any method or process, except by written permission from, or written agreement with MilesTek Corporation and its subsidiaries.

LEAD FREE SOLDER

| REVISIONS | | | |
|-----------|-----------------|------------|----------|
| REV | DESCRIPTION | DATE | APPROVED |
| A | INITIAL RELEASE | 06/18/2019 | MHEARN |
| | | | |
| | | | |

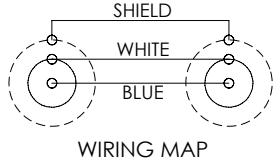
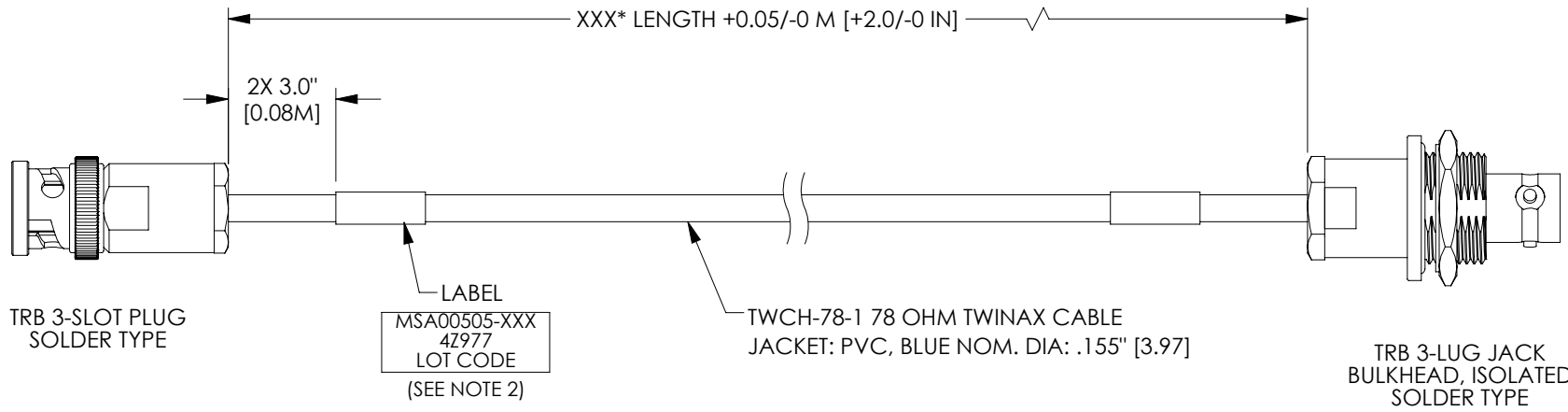

| MODEL NUMBER | LENGTH METERS [FEET] |
|---------------|----------------------|
| MSA00505-03M | 0.3 [1.0] |
| MSA00505-05M | 0.5 [1.64] |
| MSA00505-075M | 0.75 [2.46] |
| MSA00505-1M | 1.0 [3.28] |
| MSA00505-2M | 2.0 [6.56] |
| MSA00505-3M | 3.0 [9.84] |
| MSA00505-4M | 4.0 [13.12] |
| MSA00505-6M | 6.0 [19.69] |

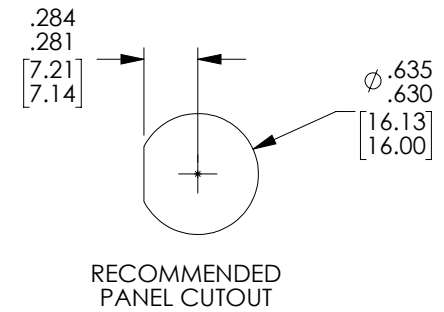

NOTES:

- *XXX = LENGTH IN INCHES
*XXXM = LENGTH IN METERS
- CABLES 48" [1.22M] AND UNDER HAVE 1 LABEL CENTERED. CABLES OVER 48" [1.22M] HAVE 2 LABELS, ONE AT EACH END. 3.0" FROM BACK OF EACH CONNECTOR.
- CABLE ASSEMBLY SHALL BE TESTED FOR CONTINUITY.
- ALL MATERIALS USED ARE CERTIFIED RoHS COMPLIANT.

| | | | | | |
|--|--|---|---|--|--|
| <small>UNLESS OTHERWISE SPECIFIED ALL DIMENSIONS ARE IN INCHES</small> <small>OVERALL CABLE LENGTH TOLERANCE:</small> ≤12 [305] = +1 [25] / -0 >12 [305] ≤60 [1524] = +2 [51] / -0 >60 [1524] ≤120 [3048] = +4 [102] / -0 >120 [3048] ≤300 [7620] = +6 [152] / -0 >300 [7620] = +5% / -0% <small>ALL OTHER DIMENSIONAL TOLERANCES:</small> X = ± 2 [5.08] .XX = ± .02 [5.1] .XXX = ± .005 [1.3] <small>CUSTOMER REFERENCE DOCUMENT:</small> | <small>SIGNATURE</small> DRAWN BY: DZINN CHECKED BY: DFRISIELLO APPROVED BY: MHEARN | <small>DATE</small> 06/18/2019 06/18/2019 06/18/2019 | MILESTEK CORPORATION 301 LEORA LANE, SUITE 100 LEWISVILLE, TX 75056 PHONE: (940) 484-9400 FAX: (940) 566-1047 | | |
| | <small>CONFIGURATION DETAILS OF UNDIMENSIONED FEATURES MAY VARY</small> | | | <small>TITLE</small> LF LSZH 0.155" O.D. 1553 TWNX P-IN BHJ | |
| | <small>CAGE CODE: 4Z977</small> | | | <small>SIZE</small> A | <small>DRAWING NUMBER:</small> MSA00505 |
| | <small>SCALE: NTS</small> | | | <small>SHEET 1 OF 1</small> | |