

PROPRIETARY NOTICE

This document discloses confidential subject matter in which MilesTek Corporation and its subsidiaries have proprietary rights. Neither receipt nor possession thereof confers or transfers any right to reproduce or disclose the document, any part thereof, any information contained therein, or any physical article or device, or to practice any method or process, except by written permission from, or written agreement with MilesTek Corporation and its subsidiaries.

MSA00426-XXXX	REVISIONS			
	REV	DESCRIPTION	DATE	APPROVED
	A	INITIAL RELEASE	07/18/17	G.HUAN
	B	ECN 8899: DELETE NOTE 2, REVISE DESCR., TITLE, ADD DETAIL	9/7/17	D.FRISIELLO
A				

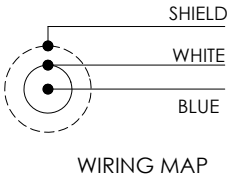
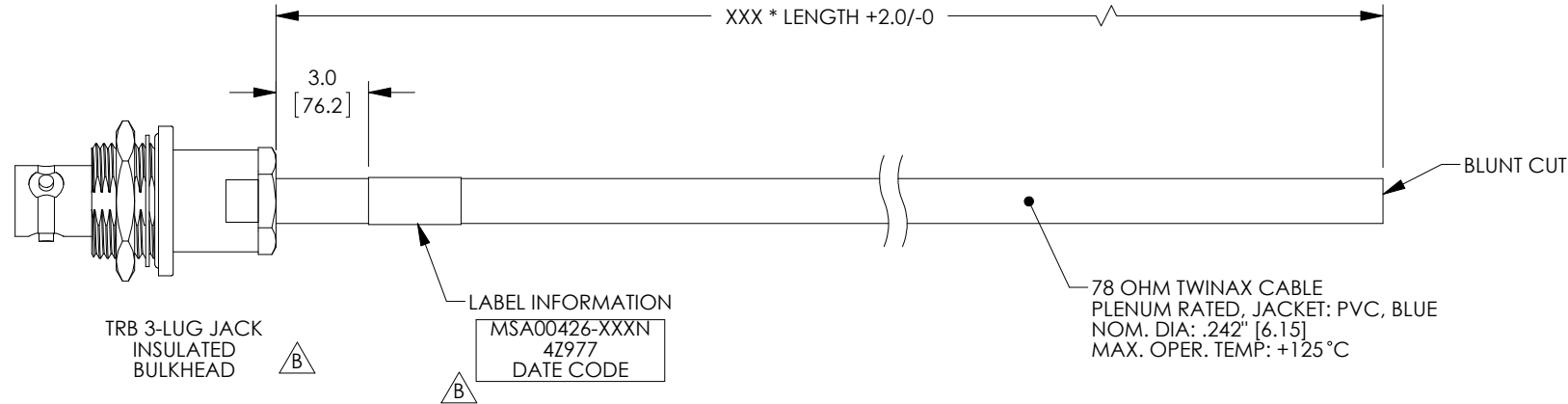

LENGTH CODE CHART		
CABLE # & LENGTH	LENGTH SYMBOL	EXAMPLES OF PART # USED
MSA00426-XXN	WHERE XXX = LENGTH IN INCHES	MSA00426-12N (12.0 INCHES)

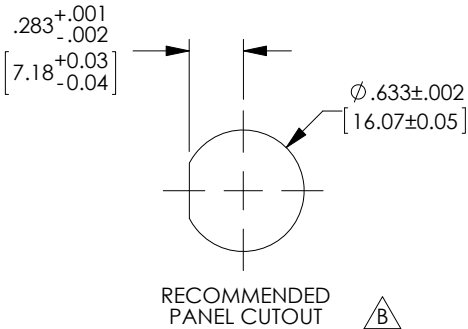

NON CONTROLLED DRAWING IF PRINTED



NOTES:

- *XXX = LENGTH IN INCHES
- CABLE ASSEMBLY SHALL BE TESTED FOR CONTINUITY.

AS9100C CERTIFIED			CAD SYSTEM DRAWING - DO NOT REVISE MANUALLY			
			SIGNATURE	DATE		
			DRAWN BY: G.HUAN	07/18/17		
			CHECKED BY: M.HEARN	07/19/17	TITLE CA PLN TWNX IN BH J-BLNT	
			APPROVED ENGINEERING: M.HEARN	07/19/17		
			APPROVED MANUFACTURING:		DRAWING NUMBER: MSA00426-XXXX	
			CUSTOMER APPROVAL			
DASH	NEXT ASSY	USED ON	CAGE CODE: 4Z977		SCALE: NTS	SHEET 1 OF 1
APPLICATION			CUSTOMER REFERENCE DOCUMENT:			