

8 7 6 5 4 3 2 1

PROPRIETARY NOTICE

This document discloses confidential subject matter in which MilesTek Corporation and its subsidiaries have proprietary rights. Neither receipt nor possession thereof confers or transfers any right to reproduce or disclose the document, any part thereof, any information contained therein, or any physical article or device, or to practice any method or process, except by written permission from, or written agreement with MilesTek Corporation and its subsidiaries.

REV	REVISIONS		
	DESCRIPTION	DATE	APPROVED
A	INITIAL RELEASE	07/18/17	G.HUAN
B	ECN 8899: DELETE NOTE 2, REVISE DESCRIPTIONS, TITLE	9/7/17	D.FRISIELLO

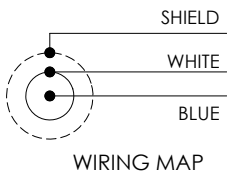
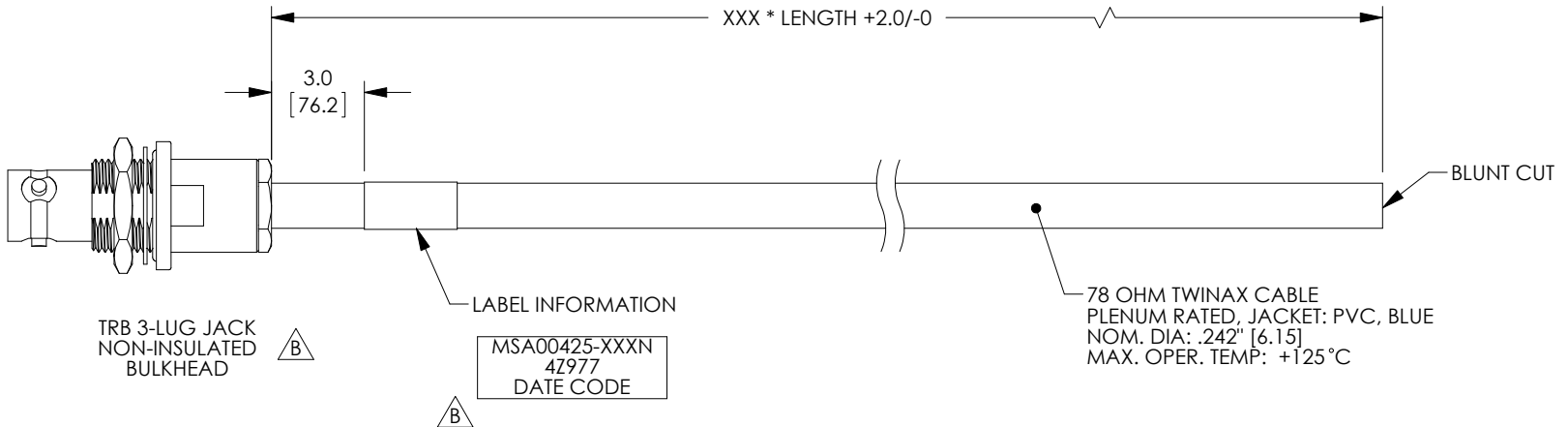

LENGTH CODE CHART		
CABLE # & LENGTH	LENGTH SYMBOL	EXAMPLES OF PART # USED
MSA00425-XXN	WHERE XXX = LENGTH IN INCHES	MSA00425-12N (12.0 INCHES)

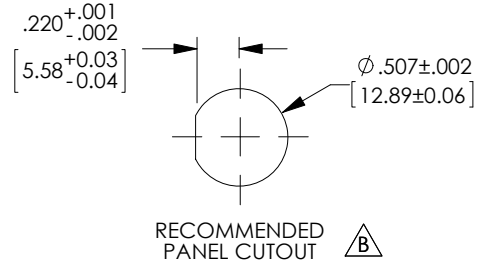

NON CONTROLLED DRAWING IF PRINTED

B

- NOTES:
- *XXX = LENGTH IN INCHES
 - CABLE ASSEMBLY SHALL BE TESTED FOR CONTINUITY.

AS9100C CERTIFIED			CAD SYSTEM DRAWING - DO NOT REVISE MANUALLY			
			SIGNATURE	DATE		MILESTEK CORPORATION 1506 INTERSTATE 35 WEST DENTON, TX 76207 PHONE: 866.524.1553 FAX: 940.591.7086
			DRAWN BY: G.HUAN	07/18/17		
			CHECKED BY: M.HEARN	07/19/17	TITLE CA PLN TWNX NI BH J-BLNT	
			APPROVED ENGINEERING: M.HEARN	07/19/17		
			APPROVED MANUFACTURING:		SIZE A	
			CUSTOMER APPROVAL			
DASH	NEXT ASSY	USED ON	CUSTOMER REFERENCE DOCUMENT:		DRAWING NUMBER: MSA00425-XXXX	
APPLICATION			CAGE CODE: 42977			
					SCALE: NTS	SHEET 1 OF 1

8 7 6 5 4 3 2 1