

PROPRIETARY NOTICE

This document discloses confidential subject matter in which MilesTek Corporation and its subsidiaries have proprietary rights. Neither receipt nor possession thereof confers or transfers any right to reproduce or disclose the document, any part thereof, any information contained therein, or any physical article or device, or to practice any method or process, except by written permission from, or written agreement with MilesTek Corporation and its subsidiaries.

REVISIONS			
REV	DESCRIPTION	DATE	APPROVED
A	INITIAL RELEASE	06/02/17	J.YOU

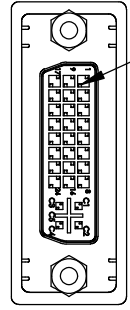

"J1"
FEMALE DVI-A
CONNECTOR

2X #4-40 HEX
JACK SCREW
(REMOVABLE)

PIN 1

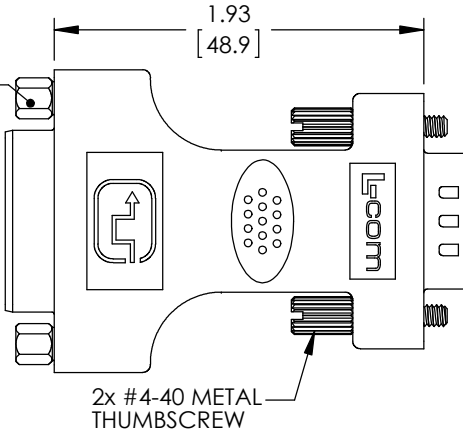

2x #4-40 METAL
THUMBSCREW

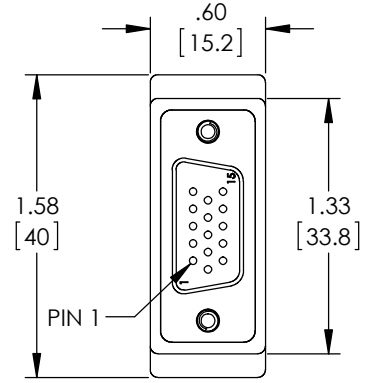

"P1"
15-PIN MALE
HIGH DENSITY
D-SUB CONNECTOR

WIRING TABLE	
"P1"	"J1"
1	C1
2	C2
3	C3
13	C4
6, 7, 8	C5
15	6
12	7
14	8
9	14, 16
5, 10	15
SHELL	SHELL

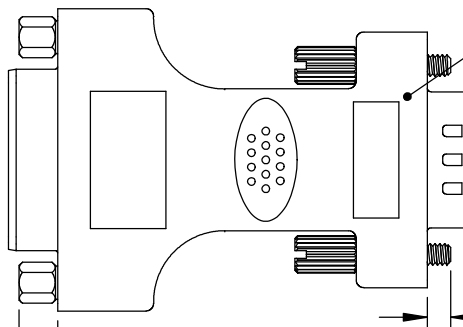
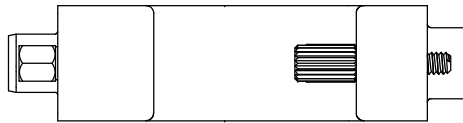

MOLDED HOOD,
PVC, LIGHT GRAY
(PANTONE 400C)
WITH 360° FOIL SHIELDING

2X .122 ^{+0.10}
 _{-.018}
[3.1] ^{+0.25}
 _{-.045}

NON CONTROLLED DRAWING IF PRINTED

NOTES:

- ADAPTOR IS SHIPPED WITH DUST COVERS ASSEMBLED (NOT SHOWN).
- ADAPTOR SHALL BE TESTED FOR CONTINUITY.
- ADAPTOR SHALL BE INDIVIDUALLY PACKAGED IN ACCORDANCE WITH SPEC. PS-0054.

REGULATORY COMPLIANCE:
CE2011/65/EU (RoHS DIRECTIVE)

AS9100C CERTIFIED			CAD SYSTEM DRAWING - DO NOT REVISE MANUALLY			
UNLESS OTHERWISE SPECIFIED ALL DIMENSIONS ARE IN INCHES			SIGNATURE	DATE	MilesTek	
OVERALL CABLE LENGTH TOLERANCE: ≤12 [305] = +1 [25] / -0 >12 [305] ≤60 [1524] = +2 [51] / -0 >60 [1524] ≤120 [3048] = +4 [102] / -0 >120 [3048] ≤300 [7620] = +6 [152] / -0 >300 [7620] = +5% / -0%			DRAWN BY: J.YOU	06/02/17	MILESTEK CORPORATION 1506 INTERSTATE 35 WEST DENTON, TX 76207 PHONE: 866.524.1553 FAX: 940.591.7086	
ALL OTHER DIMENSIONAL TOLERANCES: .X = ±.2 [5.08] .XX = ±.02 [51] .XXX = ±.005 [13]			CHECKED BY: Brian G.	06/02/17	TITLE ADAPTOR DVI-A FEMALE/HD15 MALE	
DASH NEXT ASSY USED ON			APPROVED ENGINEERING: S.PAN	06/02/17	DRAWING NUMBER: MDC00002	
APPLICATION			APPROVED MANUFACTURING:	CUSTOMER APPROVAL	SCALE: NTS SHEET 1 OF 1	
CUSTOMER REFERENCE DOCUMENT:			CAGE CODE: 42977			