

PROPRIETARY NOTICE

This document discloses confidential subject matter in which MilesTek Corporation and its subsidiaries have proprietary rights. Neither receipt nor possession thereof confers or transfers any right to reproduce, distribute, disclose, or use any physical article or device, or to practice any method or process, except by written permission from, or written agreement with MilesTek Corporation and its subsidiaries.

WIRE MAP	
DB15	TERMINAL BLOCK
1	1
2	2
3	3
4	4
5	5
6	6
7	7
8	8
9	9
10	10
11	11
12	12
13	13
14	14
15	15
SHELL	GND

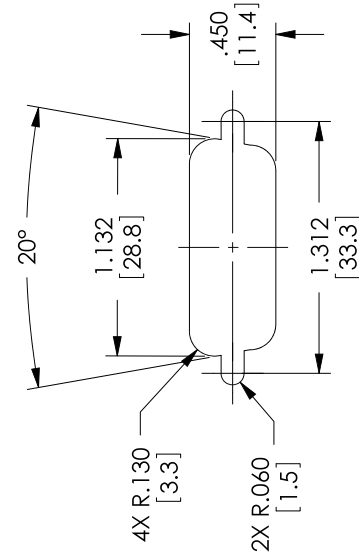
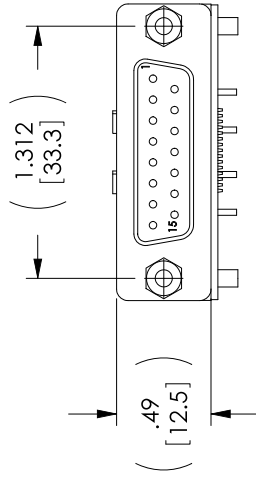
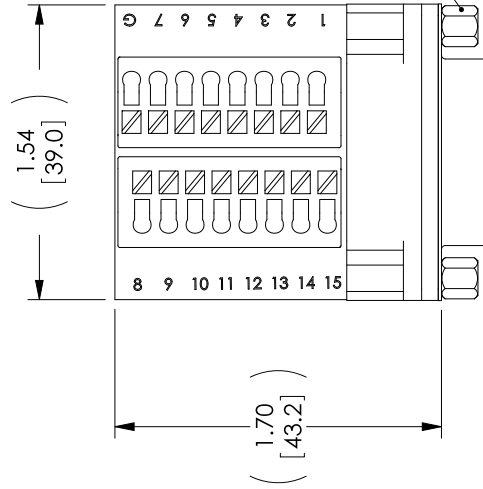

RECOMMENDED PANEL OPENING  
(MAX PANEL THICKNESS: 0.06")

NOTES:

1. VOLTAGE RATING: 1000V AC & 500V DC
2. COMPONENT SHALL BE TESTED FOR CONTINUITY.
3. COMPONENT SHALL BE INDIVIDUALLY PACKAGED IN ACCORDANCE WITH MILESTEK SPEC. PS-0054.

REV	DESCRIPTION	DATE	APPROVED
A	REV A DRAWING RELEASED	12/21/2018	BPUCHASKI

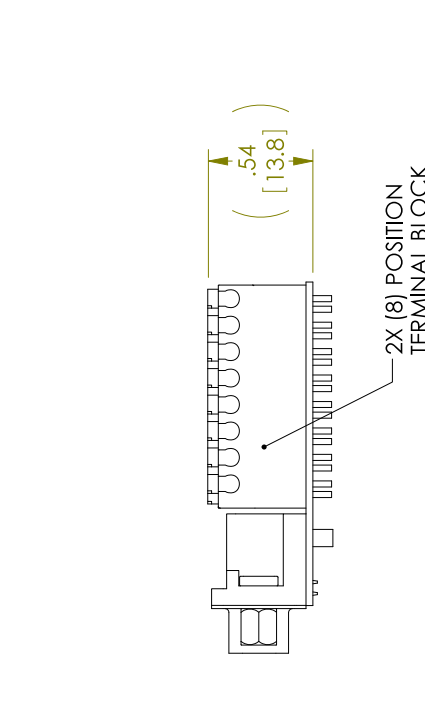
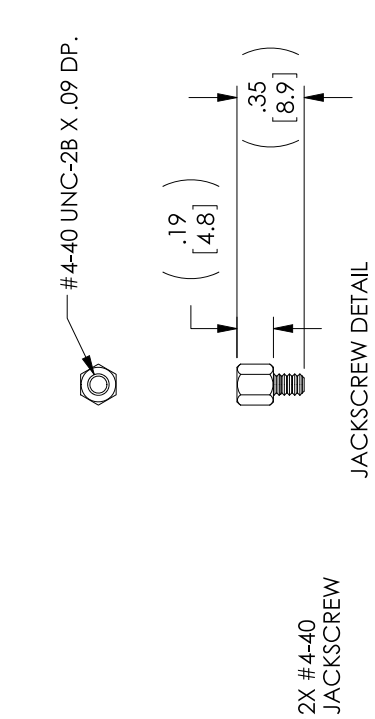

		MILESTEK CORPORATION 301 LEVY RD., SUITE 100 WASHINGTON, VA 22191 PHONE: (940) 484-9400 FAX: (940) 564-1047	
SIGNATURE	DATE	SIGNATURE	DATE
BPUCHASKI	12/14/2018	BPUCHASKI	12/14/2018
DFRIBELLO	12/17/2018	DFRIBELLO	12/17/2018
BGATES	12/14/2018	BGATES	12/14/2018
CONFIGURATION DETAILS OF UNDIMENSIONED FEATURES MAY VARY		CONFIGURATION DETAILS OF UNDIMENSIONED FEATURES MAY VARY	
UNLESS OTHERWISE SPECIFIED ALL DIMENSIONS ARE IN INCHES OVERALL CABLE LENGTH TOLERANCE: <math>< 10 [253]</math> = +1 [25] / -0 [0] <math>< 10 [253]</math> <math>< 100 [2540]</math> = +1 [25] / -0 [0] <math>> 100 [2540]</math> = +1.5 [38] / -0 [0] <math>> 500 [12700]</math> = +5% / -5% ALL OTHER DIMENSIONAL TOLERANCES: .XX = ±.005 [0.127] .XXX = ±.002 [0.051]		TITLE DB15 FEMALE CONNECTOR FOR FIELD TERMINATION WITH SCREWLESS TERMINAL BLOCK	
CUSTOMER REFERENCE DOCUMENT:		SEE DRAWING NUMBER:	
CAGE CODE: 4Z977		SCALE: NTS	
REV. A		REV. A	
DSB00123		SHEET 1 OF 1	