

CONCENTRIC TWINAX 450 SERIES

450 Series

Intermediate Contact Assemblies

PIN/SOCKET PS450AC-

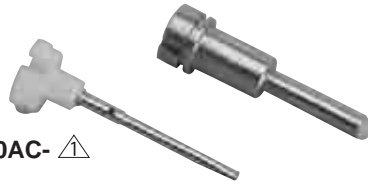

SOCKET/PIN SP450AC-



The 450 Series includes cable jacks and plugs with interchangeable contact assemblies. The contact and body assemblies may be ordered separately (see the facing page). Cable connectors accept cables with a maximum outer diameter of .180" and conductors to .025".

Contact the factory for exact specifications. For Trompeter connectors which meet outgassing requirements, contact our technical support staff for more information. Compatible with Raychem DK-621 Series. *Refer to page 24 for Keyings.*

BULKHEAD CABLE JACK REAR MOUNT, ALL CRIMP		COUPLING TYPE	KEY CODE	BODY ASSEMBLY ONLY	ASSEMBLY INTERMEDIATE CONTACT	
					PIN	SOCKET
<p>BJ459ACFL-202</p> <p>Mounting Holes: DD8.156, DD8.125 (Threaded)</p>	3-lug	P	BJ459ACP-	BJ459ACPP-	BJ459ACPS-	
	3-lug	R	BJ459ACR-	BJ459ACRP-	BJ459ACRS-	
	3-lug	W	BJ459ACW-	BJ459ACWP-	BJ459ACWS-	
	4-lug	FL	BJ459ACFL-	BJ459ACFLP-	BJ459ACFLS-	
	Threaded	-	BJ3459AC-	BJ3459ACP-	BJ3459ACS-	

CABLE JACK ALL CRIMP		COUPLING TYPE	KEY CODE	BODY ASSEMBLY ONLY	ASSEMBLY INTERMEDIATE CONTACT	
					PIN	SOCKET
<p>CJ450ACFLP-202</p>	3-lug	P	CJ450ACP-	CJ450ACPP-	CJ450ACPS-	
	3-lug	R	CJ450ACR-	CJ450ACRP-	CJ450ACRS-	
	3-lug	W	CJ450ACW-	CJ450ACWP-	CJ450ACWS-	
	4-lug	FL	CJ450ACFL-	CJ450ACFLP-	CJ450ACFLS-	
	Threaded	-	CJ3450AC-	CJ3450ACP-	CJ3450ACS-	

CABLE PLUG ALL CRIMP		COUPLING TYPE	KEY CODE	BODY ASSEMBLY ONLY	ASSEMBLY INTERMEDIATE CONTACT	
					PIN	SOCKET
<p>PL455ACR-221</p>	3-lug	P	PL455ACP-	PL455ACPP-	PL455ACPS-	
	3-lug	R	PL455ACR-	PL455ACRP-	PL455ACRS-	
	3-lug	W	PL455ACW-	PL455ACWP-	PL455ACWS-	
	4-lug	FL	PL455ACFL-	PL455ACFLP-	PL455ACFLS-	
	Threaded	-	PL3455AC-	PL3455ACP-	PL3455ACS-	

RFI PLUG CAPS & TERMINATIONS PLUGS FOR USE WITH 450 SERIES JACKS			
COUPLING TYPE	RFI CAPS	TERMINATIONS INTERMEDIATE CONTACT	
		PIN TO MATE WITH SOCKETS	SOCKETS TO MATE WITH PINS
3-lug	RFI455-	TNG451P- -R	TNG451S- -R
3-lug	RFI455-	TNG451P- -R	TNG451S- -R
3-lug	RFI455-	TNG451P- -R	TNG451S- -R
4-lug	RFI455FL-	TNG451FLP- -R	TNG451FLS- -R
Threaded	RFI3455-	TNG3451P- -R	TNG3451S- -R

Refers to Cable Group Table see pages 82-124. Chain options see page 67. "D" mounting holes see page 63.