

TOOLS & ACCESSORIES

Crimp Tools



8-POINT CRIMP TOOL 75Ω CENTER CONTACT PIN (HANDLE COLOR)

- BNC/TNC PLUGS (RED) **010-0055**
- PL11 PATCH PLUGS (BLUE) **010-0070**
- BNC/PL11 PATCH PLUGS (RED/BLUE) **010-0097**
- BNC JACK AND PLUG (BLUE) **010-0088**

12-POINT CRIMP TOOL 75Ω CENTER CONTACT PIN (HANDLE COLOR)

- BNC/TNC (YELLOW) **010-0080**
- BNC/TNC/PL11 PATCH PLUG (GREEN/YELLOW) **010-0098**



CT4L (RECOMMENDED)

CRIMP TOOL (Die not included, for crimp dies see below)

FRAME **CT4L (BLACK W/ LONGER ERGONOMIC HANDLE)**

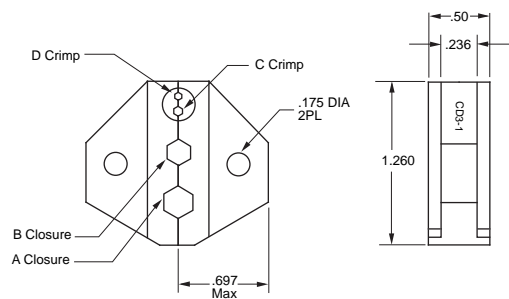

Outer Sleeve	A	Embosses	B	Embosses
CD3-1	.213	1A	.178	1B
CD3-2	.324	2A	.255	2B
CD3-3	.344	3A	.290	3B
CD3-5	-	-	.197	5B
CD3-21	.290	290	.255	255
CD3-22	.404	404	.068	-

For crimp dies not listed, call the factory.

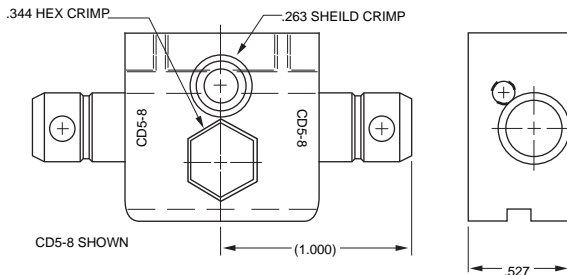

For Standard and Miniature Twinax/Triax patching: 70 Series: TRB/TRT, 150 Series: TRS/TTM, 450 Series: 2-lug/3-lug/threaded connectors.



TWINAX/TRIAX CRIMP TOOL

FOR BUSHING/SHIELD

- CRIMP TOOL ONLY **M22520/5-01**
- CRIMP TOOL WITH DIE **M22520/5-01/CD5-#**

Connector Series	Cable Type	Cable Group#	Bushing/Shield Crimp Die	Center Contact Crimp Tool Part #	Center Contact Positioner Part #
70C PLR70C PLR155AC	Twinax	201-225	CD5-8	M22520/1-01	010-0044 Pin (TP837) 010-0045 Socket (TP838)
	Triax	301-309	CD5-10		
Small Body 150AC	Twinax	201-206, 208, 209, 217-223	CD5-9	M22520/2-01	010-0041
	Triax	301-304, 309	CD5-11		
Large Body 150AC	Twinax	207, 210, 211-216, 224-225	CD5-8	M22520/2-01	010-0043
	Triax	305-306, 308	CD5-13		
	Triax	307	CD5-10		
PL75MC	Twinax	201-225	CD5-14	M22520/2-01	010-0096
		226	CD5-15	M22520/2-01	010-0096
450AC	Twinax	201-206, 208, 209, 212, 217-223	CD5-9	M22520/2-01	010-0041
PLR450	Twinax	201-206, 208, 209, 212, 217-223	CD5-120	M22520/2-01	010-0041
SPC8P	Twinax	201-205, 217, 218, 221, 222	CD5-4	M22520/2-01	Daniels K709
SPC8S	Triax	301-303	CD5-7		

* Note: Dies imprint either cavity (A/B) or hex size onto crimp sleeve. Custom dies are available for special imprints.