

PROPRIETARY NOTICE
 This document discloses confidential subject matter in which MilesTek Corporation and its subsidiaries have proprietary rights. Neither receipt nor possession thereof confers or transfers any right to reproduce or disclose the document, any part thereof, any information contained therein, or any physical article or device, or to practice any method or process, except by written permission from, or written agreement with MilesTek Corporation and its subsidiaries.

REVISIONS			
REV	DESCRIPTION	DATE	APPROVED
A	INITIAL RELEASE	06/30/17	J.YOU
B	ECN 8899: REVISE TITLE, DESCRIPTION, ADD DETAIL	8/29/17	D.FRISIELLO

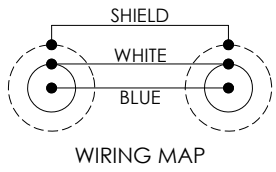

LENGTH CODE CHART		
CABLE # & LENGTH	LENGTH SYMBOL	EXAMPLES OF PART # USED
MSA00235-XXXN	WHERE XXX = LENGTH IN INCHES	MSA00235-12N (12.0 INCHES)

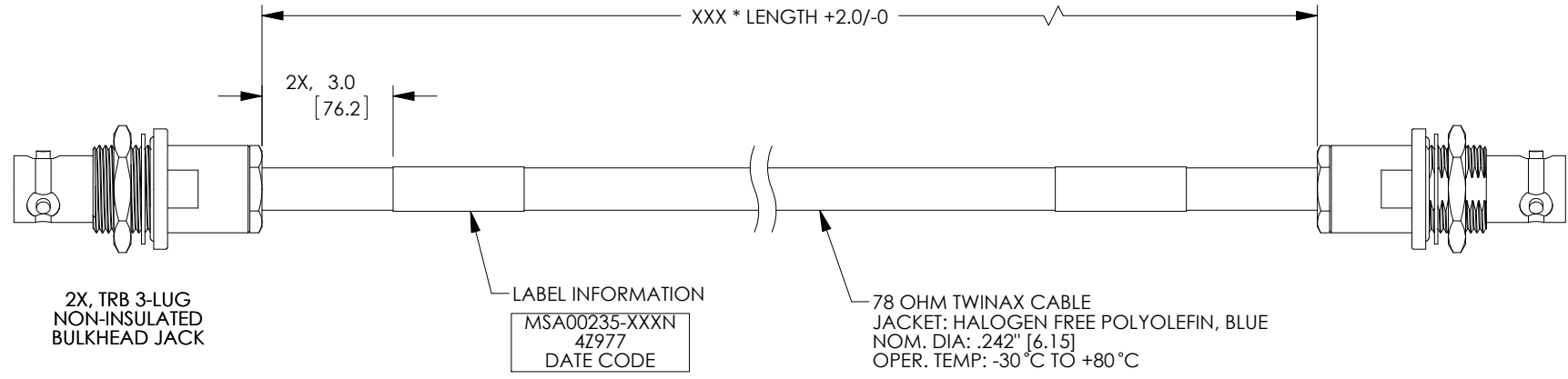
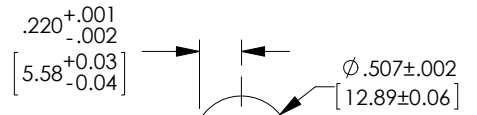

NON CONTROLLED DRAWING IF PRINTED

AS9100C CERTIFIED			CAD SYSTEM DRAWING - DO NOT REVISE MANUALLY			
UNLESS OTHERWISE SPECIFIED ALL DIMENSIONS ARE IN INCHES			SIGNATURE	DATE	MILESTEK CORPORATION 1506 INTERSTATE 35 WEST DENTON, TX 76207 PHONE: 866.524.1553 FAX: 940.591.7086	
OVERALL CABLE LENGTH TOLERANCE:			DRAWN BY:	06/30/17		
≤12 [305] = +1 [25] / -0 >12 [305] ≤60 [1524] = +2 [51] / -0 >60 [1524] ≤120 [3048] = +4 [102] / -0 >120 [3048] ≤300 [7620] = +6 [152] / -0 >300 [7620] = +5% / -0%			CHECKED BY:	06/30/17	TITLE	
ALL OTHER DIMENSIONAL TOLERANCES:			APPROVED ENGINEERING:	06/30/17	CA HF TWNX NI BH J-J	
.X = ±.2 [5.08] .XX = ±.02 [5.1] .XXX = ±.005 [1.3]			APPROVED MANUFACTURING:		DRAWING NUMBER:	
CUSTOMER REFERENCE DOCUMENT:			CUSTOMER APPROVAL		MSA00235-XXXN	
DASH	NEXT ASSY	USED ON	CAGE CODE: 4Z977		SCALE: NTS	SHEET 1 OF 1
APPLICATION						

- NOTES:**
- *XXX = LENGTH IN INCHES
 - CABLES 48" AND UNDER HAVE 1 LABEL CENTERED. CABLES OVER 48" HAVE 2 LABELS, ONE AT EACH END 3.0" FROM THE BACK OF THE CONNECTOR.
 - CABLE ASSEMBLY SHALL BE TESTED FOR CONTINUITY.