

PROPRIETARY NOTICE

This document discloses confidential subject matter in which MilesTek Corporation and its subsidiaries have proprietary rights. Neither receipt nor possession thereof confers or transfers any right to reproduce or disclose the document, any part thereof, any information contained therein, or any physical article or device, or to practice any method or process, except by written permission from, or written agreement with MilesTek Corporation and its subsidiaries.

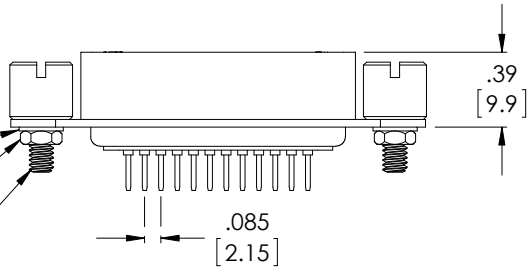

24-CONTACT FEMALE MINIATURE RIBBON CONNECTOR (PC TERMINALS)

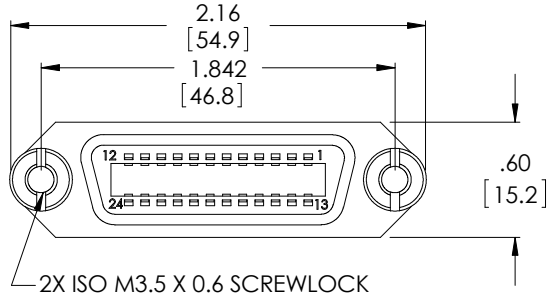
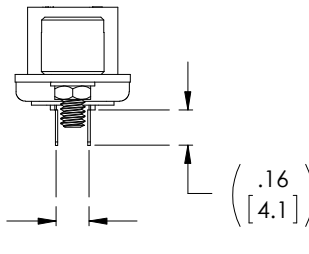

RECOMMENDED PCB HOLE LAYOUT

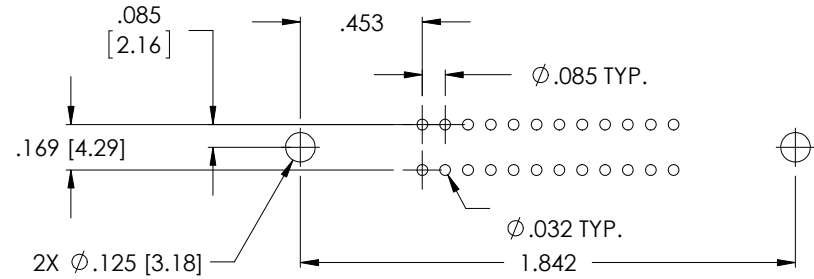

NOTES:

- MATERIALS:**
 CONTACTS: PHOSPHOR BRONZE OR BRASS
 INSULATOR: BLUE POLYBUTYLENE TEREPHTHALATE (PBT)
 U.L. 94V-0 RATED
 SHELL: STEEL, ZINC OR TIN PLATED
- FINISHES:**
 CONTACTS: GOLD PLATED
 TERMINALS: GOLD PLATED
 SHELL: NICKEL PLATED
 SCREWLOCKS: BLACK OXIDE
- SUPPLIED WITH HARDWARE ASSEMBLED.
- CONNECTOR SHALL BE INDIVIDUALLY PACKAGED IN ACCORDANCE WITH SPECIFICATION PS-0054.

REGULATORY COMPLIANCE:
 CE2011/65/EU(RoHS DIRECTIVE)

REVISIONS			
REV	DESCRIPTION	DATE	APPROVED
A	INITIAL RELEASE	06/01/17	J.YOU

NON CONTROLLED DRAWING IF PRINTED

AS9100C CERTIFIED			CAD SYSTEM DRAWING - DO NOT REVISE MANUALLY			
DASH	NEXT ASSY	USED ON	UNLESS OTHERWISE SPECIFIED ALL DIMENSIONS ARE IN INCHES	SIGNATURE	DATE	<p>MILESTEK CORPORATION 1506 INTERSTATE 35 WEST DENTON, TX 76207 PHONE: 866.524.1553 FAX: 940.591.7086</p>
			OVERALL CABLE LENGTH TOLERANCE: ≤12 [305] = +1 [25] / -0 >12 [305] ≤60 [1524] = +2 [51] / -0 >60 [1524] ≤120 [3048] = +4 [102] / -0 >120 [3048] ≤300 [7620] = +6 [152] / -0 >300 [7620] = +5% / -0% ALL OTHER DIMENSIONAL TOLERANCES: .X = ±.2 [5.08] .XX = ±.02 [5.1] .XXX = ±.005 [13]	DRAWN BY: J.YOU 06/01/17 CHECKED BY: Brian G. 06/01/17 APPROVED ENGINEERING: S.PAN 06/01/17 APPROVED MANUFACTURING: CUSTOMER APPROVAL CUSTOMER REFERENCE DOCUMENT: CAGE CODE: 42977	TITLE FEMALE IEEE-488 SOCKET, PC TERMINALS SIZE A DRAWING NUMBER: MGPB00002 SCALE: NTS SHEET 1 OF 1	
APPLICATION						